

## ARTHROSCOPY SYSTEM



### FlexHook

Part No. J108001000



### FlexStud

Part No.	Size
J107000011	11mm
J107000014	14mm
J107000020	20mm



### FlexLoop

Part No. J113000000



### KneeFix T

Part No.	Dia	Length
J112000720	7	20mm
J112000820	8	20mm
J112000920	9	20mm
J112001020	10	20mm
J112000725	7	25mm
J112000825	8	25mm
J112000925	9	25mm
J112001025	10	25mm
J112000730	7	30mm
J112000830	8	30mm
J112000930	9	30mm
J112001030	10	30mm



### KneeFix P

Part No.	Dia	Length
J106000728	7	28mm
J106000828	8	28mm
J106000928	9	28mm
J106001028	10	28mm
J106001128	11	28mm
J106001228	12	28mm



### KneeFix B

Part No.	Dia	Length
J103000728	7	28mm
J103000828	8	28mm
J103000928	9	28mm
J103001028	10	28mm
J103001128	11	28mm
J103001228	12	28mm

## INSTRUMENT SET FOR ARTHROSCOPY SYSTEM



### ACL PCL Drill Guide System

Part No. M527001000



### Obturator for Drill Guide

Part No. M528001000



**Cannulated Drill 4.5mm**

---

**Part No.** M529000045



**Flower Tip Reamer**

---

**Part No.** M505000007



**Tunnel Notcher**

---

**Part No.** M508001000



**3.5 Cannulated Screw Driver**

---

**Part No.** M512001000



**ACL Flip Cutter 9.5mm**

---

**Part No.** M532001000



**Tendon Stripper Dia 7 mm Open**

---

**Part No.** J567001000



**Tendon Stripper Dia 7 mm Closed**

---

**Part No.** J567002000

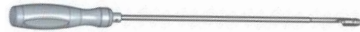

**Tendon Stripper Dia 5 mm Open**

---

**Part No.** J567003000



**Tendon Stripper Dia 5 mm Closed**

---

**Part No.** J567004000



**2.3mm Needle Drill Bit**

---

**Part No.** J566000000



**Calibrated Probe**

---

**Part No.** J501001000



**PCL Protector**

**Part No.** J502001000



**PCL Rasp**

**Part No.** J503000000



**1.2mm Guide Wire : 9 inch**

**Part No.** J504001009



**2mm Guide Wire : 9 inch**

**Part No.** J505001009



**Tunnel Plug 8, 9, 10, 11, 12**

**Part No.** J506000000

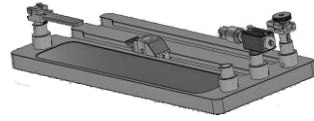

**Graft Preparation Workstation**

**Part No.** J507001000



**Rasp 20 Up**

**Part No.** J565001000



**Rasp 20 Down**

**Part No.** J565002000

**ARTHROSCOPY SYSTEM FOR SHOULDER**



**Cuffgrip-T Suture Anchor**

<b>Part No.</b>	<b>Dia</b>
J165281000	2.8mm
J166351000	3.5mm
J167501000	5.0mm

**INSTRUMENT FOR ROTOGRIP**



**ROTOGRIP**

---

<b>Part No.</b>	<b>Dia</b>	<b>Length</b>
J115001000	4.75	24.5mm
J115002000	5.50	24.5mm

Following instruments are Also available

**Probe 5.4mm**

**Punch 4.75mm & 5.50mm**

**Curette Both Sides Cut**

**Double Loaded Suture Needle**

**Double Loaded Suture Handler**

**Shoulder Tissue elevator 15° & 30°**

**Note:**

- # Shoulder systems are sold together as an assembly of Implant, Suture & Inserter.
- Inserter is single use only.